



powerbone[®]
Dental Implant

SLA ACTIVE SURFACE

ABOUT US



Bonegraft Biomaterials was Co. has become one of the global leaders in synthetic and bioresorbable biomaterials. Bonegraft Biomaterials Co. has also been manufacturing SLA Plasma Active Dental Implant that accelerates osseointegration process. Our production facility is accredited according to ISO-13485 and ISO-9001 Quality management standards and all of our products carry CE mark.

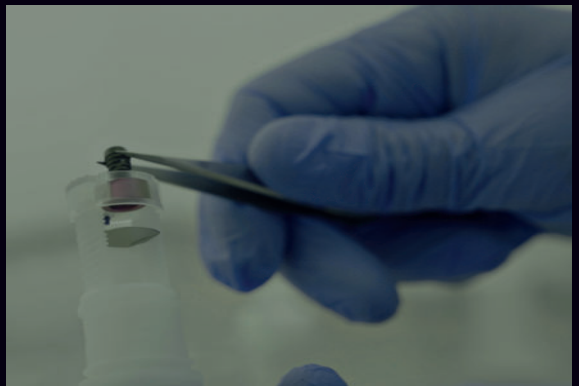

OPTIMUM ROUGHNESS

Sandblasting and etching processes applied to the implant surface ensure the adhesion of the fibrin tissue to the surface. Optimum roughness enables implant-tissue adhesion which significantly reduces osseointegration process.

HYDROPHILIC SURFACE

After with plasma treatment, dental implants become a surface with low surface tension and increased hydrophilicity. The surface roughness increases after plasma treatment.

PRESERVATION IN SOLUTION

After the plasma treatment, the implant is kept in the solution to maintain the surface activation of the implant. After the implant is removed from the solution, the chemical activity of the SLA Active surface is maintained for 15 minutes.

PLASMA TREATMENT

Plasma treatment reduces the surface wetting angle and increase hydrophilicity. Hydrophilic surface enhances cell adhesion and proliferation on dental implants. Therefore, accelerated osseointegration can be achieved.

SLA ACTIVE SURFACE

In addition to conventional sandblasting and etching processes applied to the dental implant surface, the SLA active surface is subjected to plasma treatment, which significantly increases the surface activation. Compared to the SLA surface, the SLA-active surface becomes rougher and more hydrophilic, greatly accelerating the osseointegration process.



Implant design provides optimum primer stability

BEVELED NECK

It prevents bone loss by reducing the stress in the neck area.

SPIRAL FLUTE

It collects bone particles and distributes them throughout the body.

SLA ACTIVE SURFACE

Optimum roughness, fast osseointegration process, low contact angle, high hydrophilic surface.

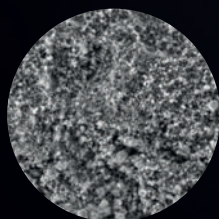

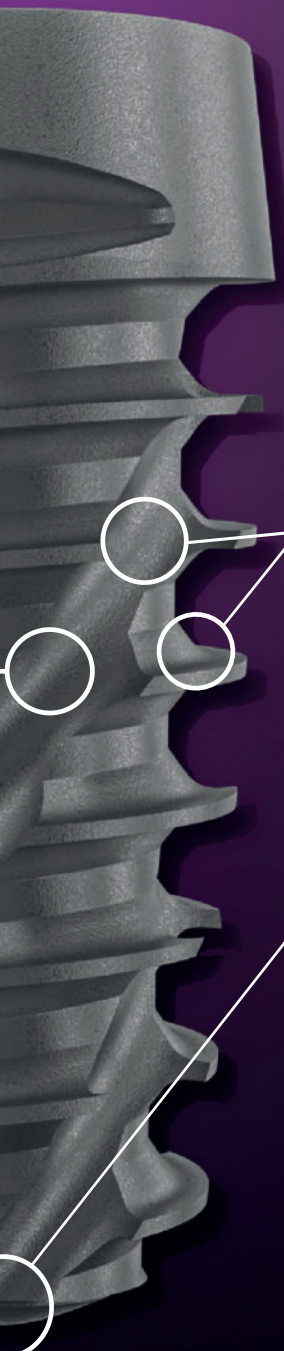

THREAD DESIGN

Fine and staggered groove design that increases implant contact with bone and provides high primary stability.

BIDIRECTIONAL CUTTING

Provides forward and backward cutting control during implant placement.

ROUNDED PEAK

It does not damage the mandibular nerve canal and sinuses.

DEEP CONICAL CONNECTION

With the 5° conical hexagonal connection, the forces coming to the implant -abutment- connection screw are distributed and prevented from gathering at a single point.

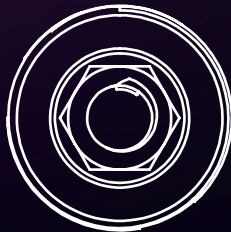

3,3-8,00 mm		Power-396.0033080
3,3-10,00 mm		Power-396.0033100
3,3-11,50 mm		Power-396.0033115
3,3-13,00 mm		Power-396.0033130

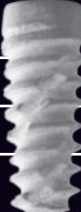
3,8-08,00 mm		Power-396.0038080
3,8-10,00 mm		Power-396.0038100
3,8-11,50 mm		Power-396.0038115
3,8-13,00 mm		Power-396.0038130

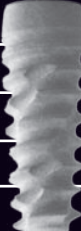
4,2-06,00 mm		Power-396.1042060
4,2-08,00 mm		Power-396.0042080
4,2-10,00 mm		Power-396.0042100
4,2-11,50 mm		Power-396.0042115
4,2-13,00 mm		Power-396.0042130

4,6-06,00 mm		Power-396.1046060
4,6-08,00 mm		Power-396.1046080
4,6-10,00 mm		Power-396.1046100
4,6-11,50 mm		Power-396.1046115
4,6-13,00 mm		Power-396.1046130

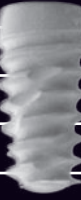
5,0-06,00 mm		Power-396.1050060
5,0-08,00 mm		Power-396.0050080
5,0-10,00 mm		Power-396.0050100
5,0-11,50 mm		Power-396.0050115
5,0-13,00 mm		Power-396.0050130

High strength results were obtained from mechanical tests performed in accordance with ISO 14801 and TS/ISO 13498 Standards.

INTERNAL CONICAL CONNECTION

5° inner-conical connection reducing load absorption under lateral forces



HEXOGONAL CONNECTION

Hexagonal indexing for anti-rotation safety

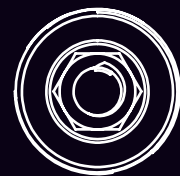

SWITCH PLATFORM

Stress-relieving platform in the neck area

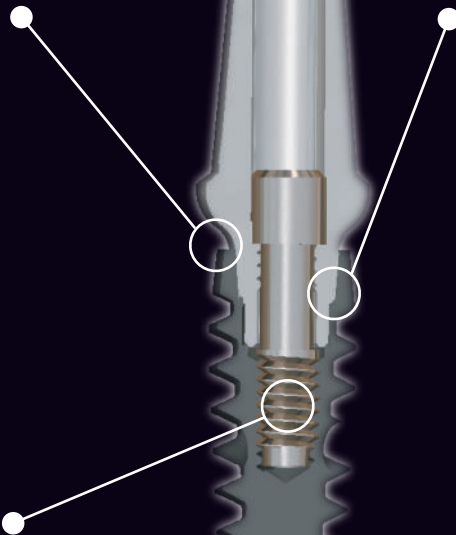

INTERNAL CONNECTIVITY

Internal grooves to hold the fittings together with the root M 1.8

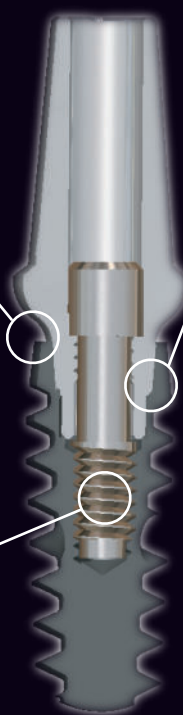

CEMENT-RETAINED SOLUTIONS

STRAIGHT ABUTMENT

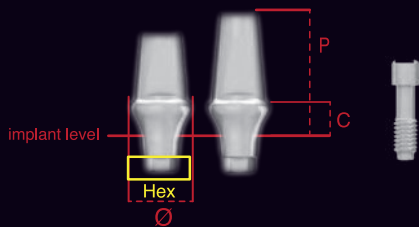

Ø: Profile Diameter P: Straight Height C: Gingiva Height

Power-396.5000001-01	Ø4,0 / C = 2,0 / P = 7 / HEX
Power-396.5000001-02	Ø4,0 / C = 3,0 / P = 7 / HEX
Power-396.5000001-03	Ø4,0 / C = 4,0 / P = 7 / HEX
Power-396.5000001-04	Ø4,0 / C = 5,0 / P = 7 / HEX
Power-396.5000002-01	Ø5,0 / C = 2,0 / P = 7 / HEX
Power-396.5000002-02	Ø5,0 / C = 3,0 / P = 7 / HEX
Power-396.5000002-03	Ø5,0 / C = 4,0 / P = 7 / HEX
Power-396.5000002-04	Ø5,0 / C = 5,0 / P = 7 / HEX

ANGLED ABUTMENT

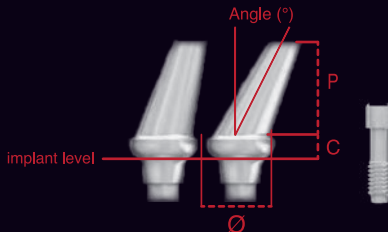

Ø: Profile Diameter P: Straight Height C: Gingiva Height

Power-396.5000007-01	Ø4,0 / C = 2,0 / 15°
Power-396.5000008-01	Ø4,0 / C = 3,0 / 15°
Power-396.5000009-01	Ø4,0 / C = 4,0 / 15°
Power-396.5000010-01	Ø4,0 / C = 5,0 / 15°
Power-396.5000007-02	Ø5,0 / C = 2,0 / 15°
Power-396.5000008-02	Ø5,0 / C = 3,0 / 15°
Power-396.5000009-02	Ø5,0 / C = 4,0 / 15°
Power-396.5000010-02	Ø5,0 / C = 5,0 / 15°
Power-396.5000007-03	Ø6,0 / C = 2,0 / 15°
Power-396.5000008-03	Ø6,0 / C = 3,0 / 15°
Power-396.5000009-03	Ø6,0 / C = 4,0 / 15°
Power-396.5000010-03	Ø6,0 / C = 5,0 / 15°
Power-396.5000012-01	Ø4,0 / C = 2,0 / 25°
Power-396.5000011-01	Ø4,0 / C = 3,0 / 25°
Power-396.5000011-02	Ø4,0 / C = 4,0 / 25°
Power-396.5000011-03	Ø4,0 / C = 5,0 / 25°
Power-396.5000012-02	Ø5,0 / C = 2,0 / 25°
Power-396.5000011-04	Ø5,0 / C = 3,0 / 25°
Power-396.5000011-05	Ø5,0 / C = 4,0 / 25°
Power-396.5000011-06	Ø5,0 / C = 5,0 / 25°

CUSTOM SOLUTIONS

DIGITAL SYSTEM



Power-396.5000016-01 SCAN ABUTMENT Ø4,0-9,00 MM

Power-396.5000016-02 SCAN ABUTMENT Ø4,0-13,00 MM



Power-396.5000014-05

Scan Analog

TI-BASE ABUTMENT

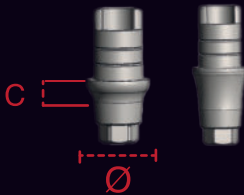

Power-396.5000015-02 Ø4-C1,5-P4,5

Power-396.5000015-03 Ø4-C3-P4,5



Power-396.5000015-09

Ø4-C0,6-P6

OVERDENTURE PROSTHESIS SOLUTIONS

BALL ATTACHMENT ABUTMENT



Power-396.5000025-05 C=0MM (0,5MM)

Power-396.5000025-06 C=1MM

Power-396.5000025-07 C=2MM

Power-396.5000026-05 C=3MM

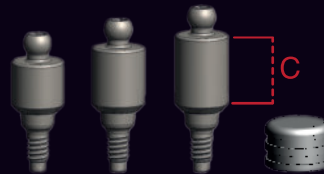

Power-396.5000027-05 C=4MM

Power-396.5000028-06 C=5MM

Power-396.5000029-05 C=6MM

Power-396.5000029-06 TITANIUM HOUSING

MULTI-UNIT SYSTEM

MULTI-UNIT ANGLED ABUTMENT



Ø: Profile Diameter C: Gingiva Height

Power-396.5000033 $\text{Ø}4,5 / C = 2,5 / 17^\circ$

Power-396.5000034 $\text{Ø}4,5 / C = 3,5 / 17^\circ$

Power-396.5000035 $\text{Ø}4,5 / C = 4,5 / 17^\circ$

Power-396.5000030 $\text{Ø}4,5 / C = 2,5 / 30^\circ$

Power-396.5000031 $\text{Ø}4,5 / C = 3,5 / 30^\circ$

Power-396.5000032 $\text{Ø}4,5 / C = 4,5 / 30^\circ$

MULTI-UNIT STRAIGHT ABUTMENT



Power-396.5000037-01 C = 1,5 / M1,8 / NONHEX

Power-396.5000037-02 C = 2,5 / M1,8 / NONHEX

Power-396.5000037-03 C = 3,5 / M1,8 / NONHEX

Power-396.5000037-04 C = 4,5 / M1,8 / NONHEX

MULTI-UNIT HEALING CAP



Power-396.5000028-05

Ø5,0 mm

MULTI UNIT Ti-FACE



Power-396.5000015-10 Titanium Face for MUA

Power-396.5000015-11 Titanium Face Screw (M1,4) for MUA

MULTI-UNIT LAB ANALOGUE

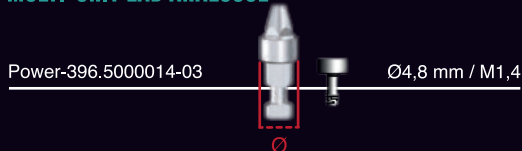

Power-396.5000014-03

Ø4,8 mm / M1,4

IMPRESSION COPING FOR CLOSE-TRAY FOR MUA

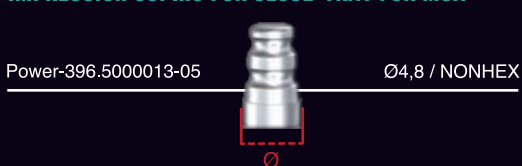

Power-396.5000013-05

Ø4,8 / NONHEX

IMPRESSION COPING FOR OPEN-TRAY FOR MUA

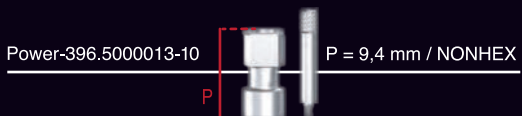

Power-396.5000013-10

P = 9,4 mm / NONHEX

AUXILIARY PROSTHESIS PARTS

LAB ANALOGUE

Power-396.5000014-01  L = 12 mm

IMPRESSION COPING FOR CLOSE-TRAY (TRANSFER TYPE)

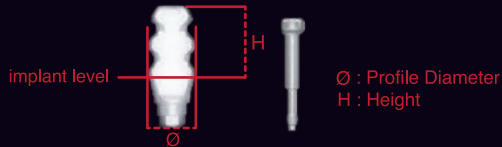

Power-396.5000013-03 12MM (Transfer type)

Power-396.5000013-04 16MM (Transfer type)

IMPRESSION COPING FOR OPEN-TRAY (PICK-UP TYPE)

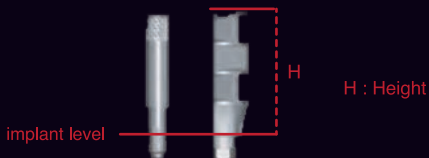

Power-396.5000013-06 H = 12 mm

HEALING ABUTMENT

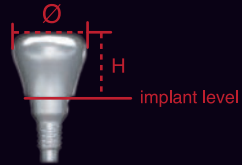

Ø : Profile Diameter
H : Height

Power-396.5000026-06 Ø4/H=2

Power-396.5000026-01 Ø4/H=3

Power-396.5000027-01 Ø4/H=4

Power-396.5000028-01 Ø4/H=5

Power-396.5000029-01 Ø4/H=6

Power-396.5000025-01 Ø4/H=7

Power-396.5000026-07 Ø5,0/H=2

Power-396.5000026-02 Ø5,0/H=3

Power-396.5000027-02 Ø5,0/H=4

Power-396.5000028-02 Ø5,0/H=5

Power-396.5000029-02 Ø5,0/H=6

Power-396.5000025-002 Ø5,0/H=7

Power-396.5000026-03 Ø6,0/H=3

Power-396.5000027-03 Ø6,0/H=4

Power-396.5000028-03 Ø6,0/H=5

Power-396.5000029-03 Ø6,0/H=6

Power-396.5000025-03 Ø6,0/H=7

Power-396.5000026-04 Ø7,0/H=3

Power-396.5000028-04 Ø7,0/H=5

ABUTMENT REMOVAL DRIVER

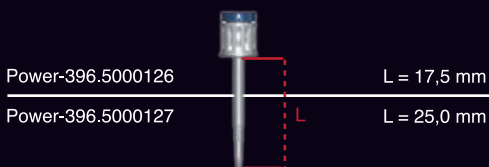

SURGICAL SET

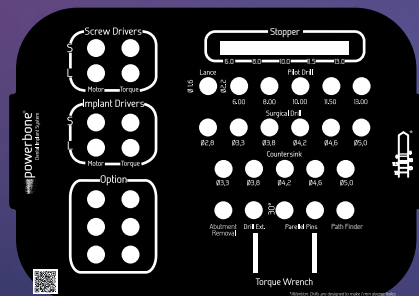

PRODUCT NAME

POINT DRILL 1,6 MM

PILOT DRILL 2,2-08,00 MM

PILOT DRILL 2,2-09,00 MM

PILOT DRILL 2,2-11,00 MM

PILOT DRILL 2,2-12,50 MM

PILOT DRILL 2,2-14,00 MM

SURGICAL DRILL 2,8 MM

SURGICAL DRILL 3,1 MM

SURGICAL DRILL 3,3 MM

SURGICAL DRILL 3,7 MM

SURGICAL DRILL 4,1 MM

SURGICAL DRILL 4,5 MM

COUNTERSINK 3,3 MM

COUNTERSINK 3,8 MM

COUNTERSINK 4,2 MM

COUNTERSINK 4,6 MM

COUNTERSINK 5,0 MM

REFERENCE CODE

Power-396.5000081K

Power-396.5000082N

Power-396.5000083N

Power-396.5000084N

Power-396.5000085N

Power-396.5000086N

Power-396.5000087N

Power-396.5000151

Power-396.5000152

Power-396.5000153

Power-396.5000154

Power-396.5000155

Power-396.5000156

Power-396.5000157

Power-396.5000158

Power-396.5000159

Power-396.5000160

PRODUCT NAME**REFERENCE CODE**

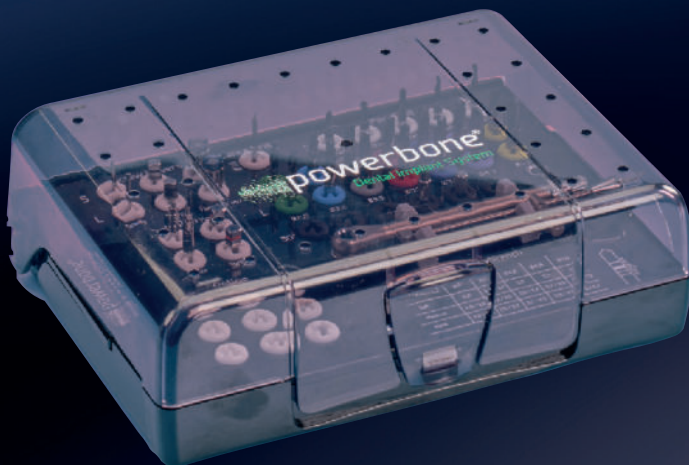

Parallel Pin for Implant	Power-396.5000145
Parallel Pin (2pcs)	Power-396.5000101
Depth Gauge	Power-396.5000104
Implant Driver (AA-2,3MM) for Motor Short	Power-396.5000107
Implant Driver (AA-2,3MM) for Motor Long	Power-396.5000108
Implant Driver (AA-2,3MM) for Motor Short	Power-396.5000107
Implant Driver (AA-2,3MM) for Motor Long	Power-396.5000108
Universal screwdriver (AA-1,2MM) for Motor Short	Power-396.5000111
Universal screwdriver (AA-1,2MM) for Motor Long	Power-396.5000112
Universal screwdriver (AA-1,2MM) for Motor Short	Power-396.5000111
Universal screwdriver (AA-1,2MM) for Motor Long	Power-396.5000112
Multi-unit Abutment Holder	Power-396.5000115
Drilling Extention	Power-396.5000116
Torque Wrench	Power-396.5000119
STOPPER for SURGICAL DRILL for 6 MM	Power-396.5000146
STOPPER for SURGICAL DRILL for 8 MM	Power-396.5000147
STOPPER for SURGICAL DRILL 10 MM	Power-396.5000148
STOPPER for SURGICAL DRILL 11.5 MM	Power-396.5000149
STOPPER for SURGICAL DRILL 13 MM	Power-396.5000150

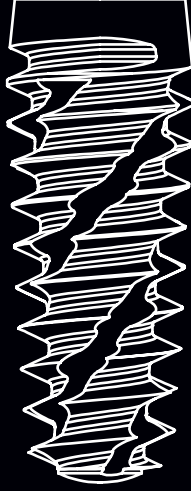

 **powerbone**[®]
Dental Implant



for website

 / powerbonedentalimplant  / powerbonedentalimplant



M.O.S.B 4. Kısım Keçiliköy OSB Mahallesi İsmail Kahraman Cad. No:1
P.C: 45030 Yunusemre / Manisa / TÜRKİYE

BONEGRAFT[®]
BIOMATERIALS



+90 236 373 33 38



info@bonegraft.com.tr



bonegraft.com.tr